

## INTRODUCTION

This supplement covers the construction, function and servicing procedures of the Honda UMK435T grass/weed trimmer.

For service information that is not covered in this supplement, please refer to the UMR435T base shop manual (part number 62VL510) and UMK435T base shop manual supplement (part number 62VL510Z).

All information contained in this manual is based on the latest product information available at the time of printing. We reserve the right to make changes at anytime without notice.

No part of this publication may be reproduced, stored in a retrieval system, or transmitted, in any form, by any means, electronic, mechanical, photocopying, recording, or otherwise, without prior written permission of the publisher. This includes text, figures, and tables.

As you read this manual, you will find information that is preceded by a **NOTICE** symbol. The purpose of this message is to help prevent damage to this Honda product, other property, or the environment.

## SAFETY MESSAGES

Your safety and the safety of others are very important. To help you make informed decisions, we have provided safety messages and other safety information throughout this manual. Of course, it is not practical or possible to warn you about all the hazards associated with servicing these products. You must use your own good judgement.

You will find important safety information in a variety of forms, including:

- Safety Labels – on the product.
- Safety Messages – preceded by a safety alert symbol

⚠ and one of three signal words, DANGER, WARNING, or CAUTION.

These signal words mean:

**⚠ DANGER** You WILL be KILLED or SERIOUSLY HURT if you don't follow instructions.

**⚠ WARNING** You CAN be KILLED or SERIOUSLY HURT if you don't follow instructions.

**⚠ CAUTION** You CAN be HURT if you don't follow instructions.

- Instructions – how to service these products correctly and safely.









OUTLINE OF CHANGES	
SPECIFICATIONS	1
SERVICE INFORMATION	2
MAINTENANCE	3
TROUBLESHOOTING	4
FUEL SYSTEM	5
IGNITION SYSTEM	6
STARTING SYSTEM	7
MUFFLER	8
CLUTCH	9
ENGINE REMOVAL/INSTALLATION	10
CRANKCASE	11
CYLINDER HEAD	12
CUTTER/GEAR CASE	13
FRAME/THROTTLE	14
INDEX	

The marked sections contain no changes.  
They are not covered in this supplement.

How to use this manual

SYMBOLS

The symbols used throughout this manual show specific service procedures. If supplementary information is required pertaining to these symbols, it will be explained specifically in the text without the use of the symbols.

	Replace the part(s) with new one(s) before assembly.
	Use the recommend engine oil, unless otherwise specified.
	Use molybdenum oil solution (mixture of the engine oil and molybdenum grease in a ratio of 1:1).
	Use multi-purpose grease (lithium based multi-purpose grease NLGI #2 or equivalent).
	Use marine grease (water resistant urea based grease).
	Apply a locking agent. Use a medium strength locking agent unless otherwise specified.
	Apply sealant.
	Use automatic transmission fluid.
(O x O) (O)	Indicates the diameter, length, and quantity of metric bolts used.
page 1-1	Indicates the reference page.

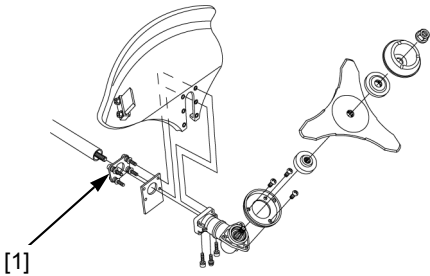
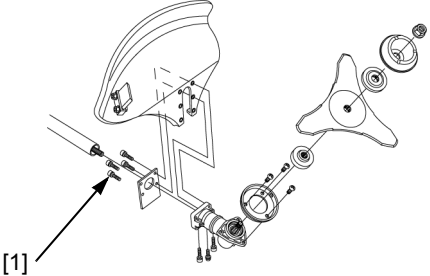
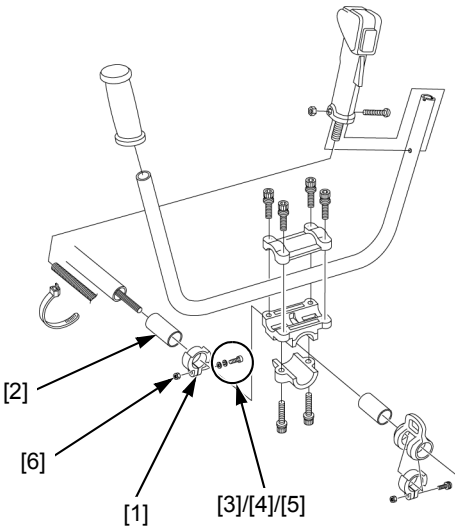
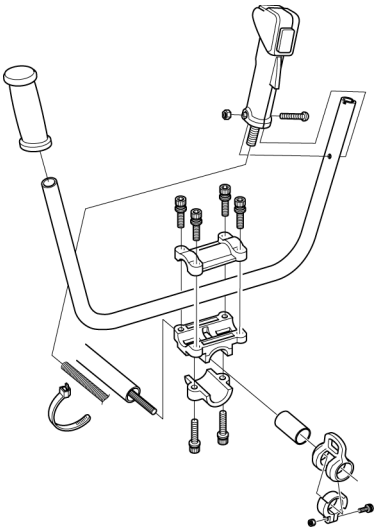
Item	UEBT type	UEDT type
SOCKET BOLT (5 x 20 mm) [1]		
HANGER B [1], COLLAR [2], TORX BOLT (5 x 20 mm) [3], SPRING WASHER [4], WASHER [5], NUT [6]		

---

## MEMO

---

SERIAL NUMBER LOCATION .....	1-2	DIMENSIONS AND WEIGHTS	
TYPE CODE .....	1-2	SPECIFICATIONS.....	1-3
		DIMENSIONAL DRAWINGS .....	1-4

SPECIFICATIONS

SERIAL NUMBER LOCATION

The engine serial number is stamped on the crankcase lower side, and the frame serial number is located on the frame pipe.

Always specify these numbers when inquiring about the engine or when ordering parts in order to obtain the correct parts for the brush cutter being serviced.

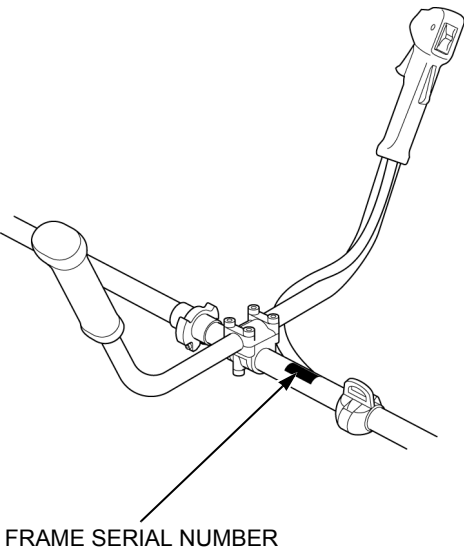
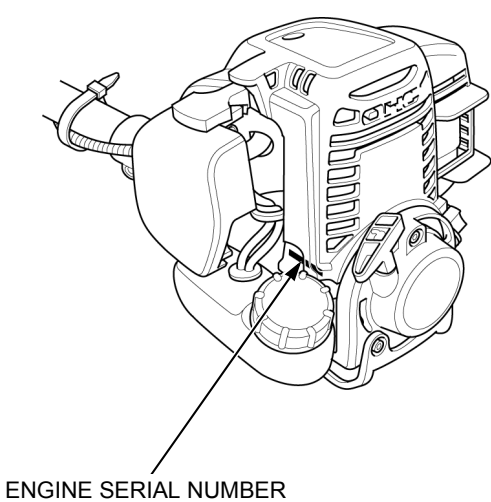

TYPE CODE

Type		UEBT
Cutting attachment	3-blade cutter	○
	Nylon cutter	○

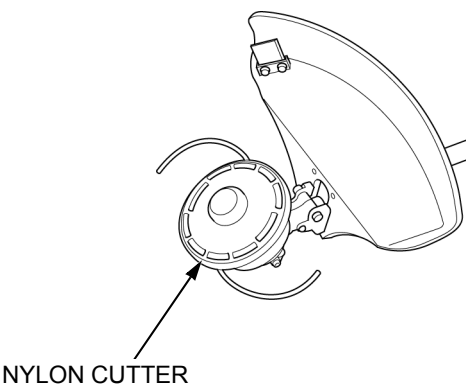
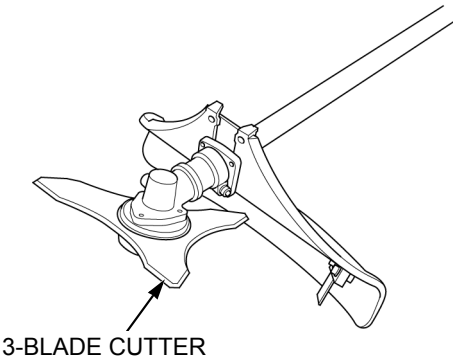

## DIMENSIONS AND WEIGHTS SPECIFICATIONS

Model		UMK435T	
Description code		HAAT	
Type		UEBT	
Cutting attachment	Type	3-blade cutter	Nylon cutter
	Diameter	255 mm (10.0 in)	440 mm (17.3 in)
	Rpm *1	8,300 min <sup>-1</sup> (rpm)	6,800 min <sup>-1</sup> (rpm)
	Weight	0.37 kg (0.82 lbs)	
Overall length		1,901 mm (74.8 in)	1,870 mm (73.6 in)
Overall width		640 mm (25.2 in)	
Overall height		420 mm (16.5 in)	440 mm (17.3 in)
Dry weight *2		7.7 kg (17.0 lbs)	
Operating weight		8.8 kg (19.4 lbs)	8.6 kg (19.0 lbs)

\*1: Maximum engine rotating speed

\*2: Without cutting attachment

## SPECIFICATIONS

# DIMENSIONAL DRAWINGS

3-Blade cutter type shown:

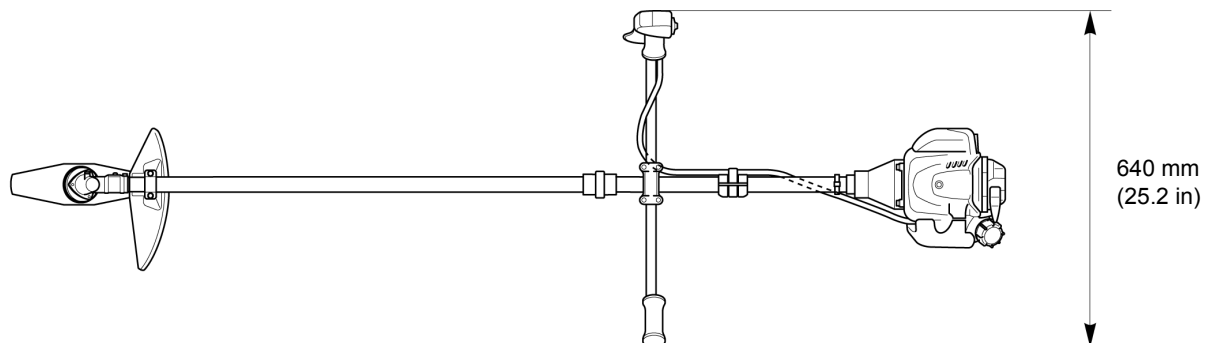

3-Blade cutter type:

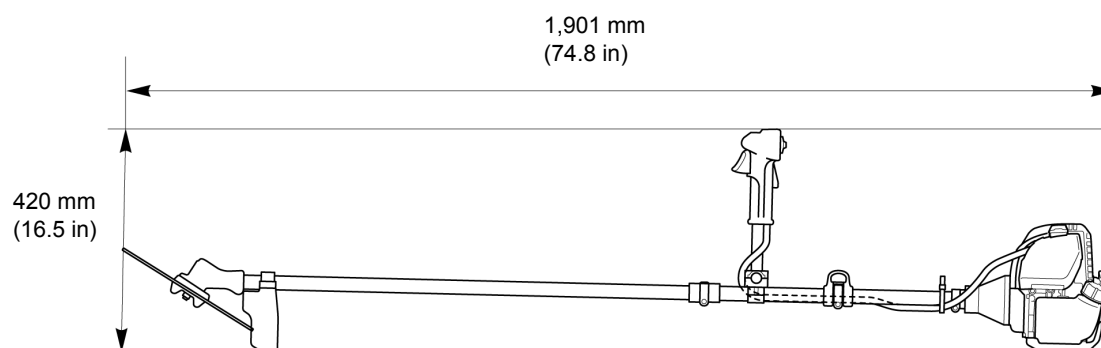

Nylon cutter type:

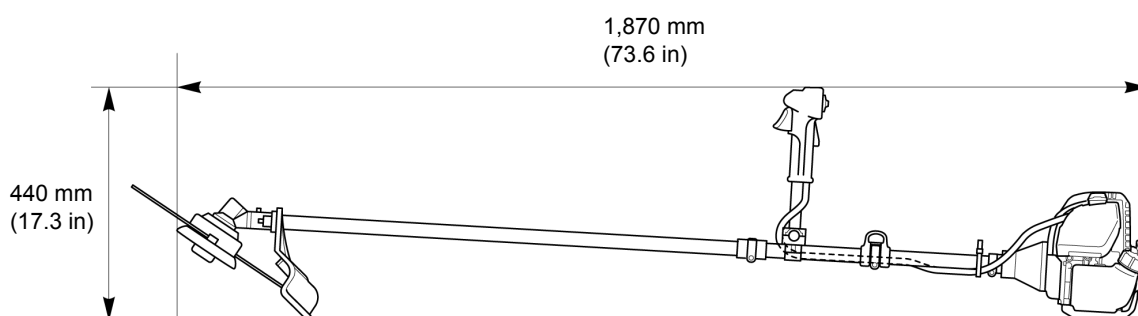



TORQUE VALUES ..... 2-2

## SERVICE INFORMATION

# TORQUE VALUES

## FRAME TORQUE VALUES

Item	Thread Dia. x Pitch mm (in)	Torque values			Remarks
		N·m	kgf·m	lbf·ft	
Hanger B mounting torx bolt	M5 x 1.0	2.5	0.26	1.8	

## STANDARD TORQUE VALUES

Item	Thread dia. (mm)	Torque values		
		N·m	kgf·m	lbf·ft
Screw	5 mm	4.2	0.43	3.1
	6 mm	9	0.92	6.6
Bolt and nut	5 mm	5	0.51	3.7
	6 mm	10	1.0	7
	8 mm	22	2.2	16
	10 mm	34	3.5	25
Flange bolt and nut	6 mm	12	1.2	9
	8 mm	26	2.7	20

# 13. CUTTER/GEAR CASE

---

BLADE CUTTER/GEAR CASE/DEFLECTOR REMOVAL/INSTALLATION .....	13-2
NYLON CUTTER/GEAR CASE/ DEFLECTOR REMOVAL/INSTALLATION .....	13-3

# BLADE CUTTER/GEAR CASE/ DEFLECTOR REMOVAL/ INSTALLATION

### ⚠ WARNING

- Turn the engine stop switch to the STOP position and remove the spark plug cap before removing the blade cutter/gear case.
- Be sure to remove wear gloves to protect your hands.

#### GRASS DEFLECTOR

##### INSPECTION:

Check the grass deflector for cracks and damage, and replace with new one if necessary.

#### SPECIAL NUT

(Left-hand threads; 10 mm)  
24.2 N·m (2.5 kgf·m, 18 lbf·ft)

#### NUT COVER

#### BLADE HOLDER B

#### 3-BLADE CUTTER

##### INSPECTION:

Check the blade cutter for wear and damage, and replace with new one if necessary.

#### FRAME PIPE

#### BLADE HOLDER A

#### SCREW (5 x 10 mm) (3)

4.2 N·m (0.43 kgf·m, 3.1 lbf·ft)

#### PROTECTOR HOLDER

#### SOCKET BOLT (5 x 20 mm) (4)

5.2 N·m (0.53 kgf·m, 3.8 lbf·ft)

#### SOCKET BOLT (6 x 25 mm) (2)

9.0 N·m (0.92 kgf·m, 6.6 lbf·ft)

#### GEAR CASE

#### SCREW/WASHER (5 x 14 mm)

4.2 N·m (0.43 kgf·m, 3.1 lbf·ft)

#### GRASS GUARD

# NYLON CUTTER/GEAR CASE/ DEFLECTOR REMOVAL/ INSTALLATION

## **⚠ WARNING**

- Turn the engine stop switch to the STOP position and remove the spark plug cap before removing the nylon cutter/gear case.
- Be sure to remove wear gloves to protect your hands.

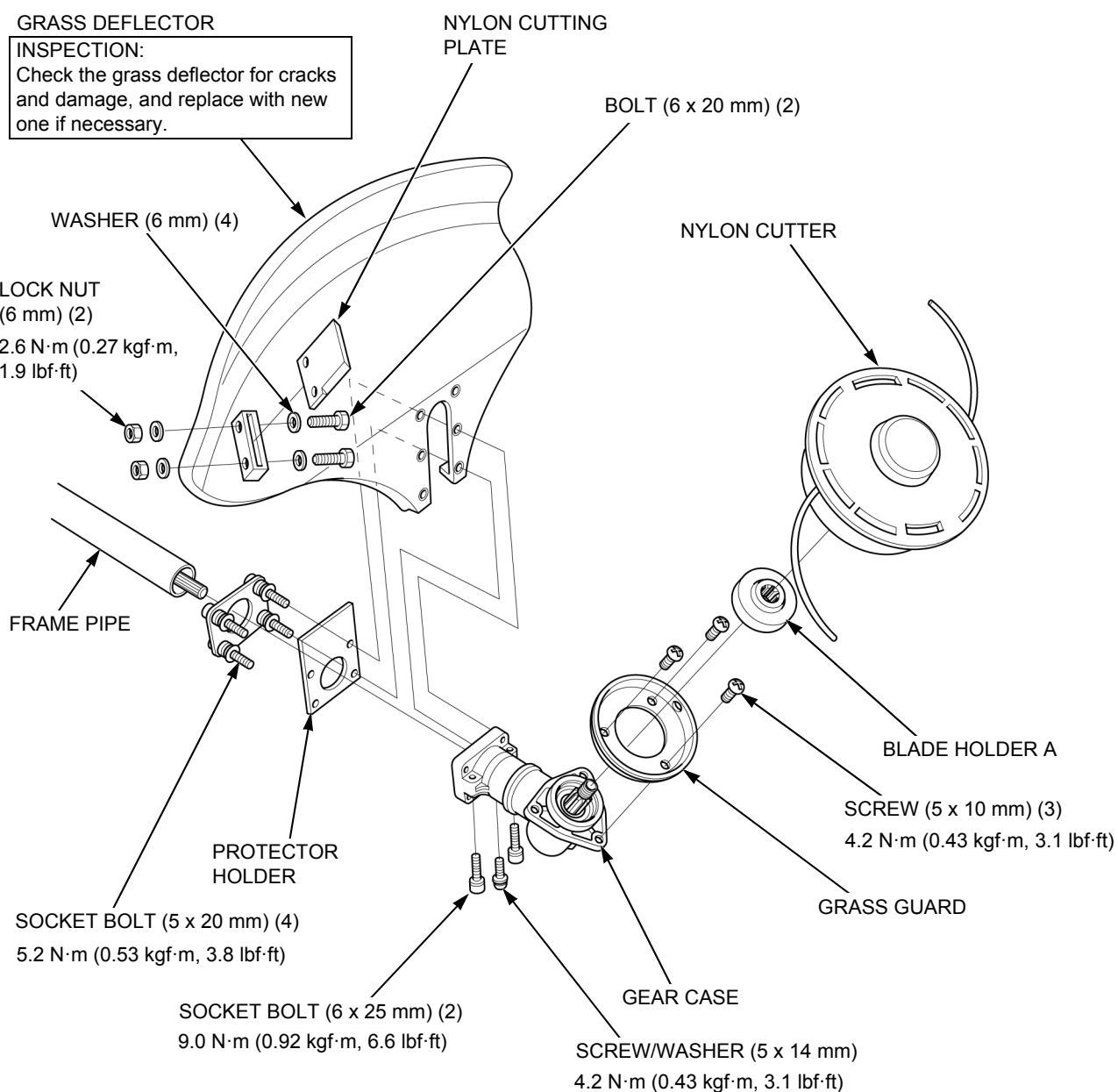

---

## MEMO

LOOP HANDLE/THROTTLE LEVER  
REMOVAL/INSTALLATION ..... 14-2

## LOOP HANDLE/THROTTLE LEVER REMOVAL/INSTALLATION

Remove the following:

- Frame pipe (Base shop manual 62VL510Z: page 14-2)
- Gear case/grass deflector:
  - Blade cutter (page 13-2)
  - Nylon cutter (page 13-3)

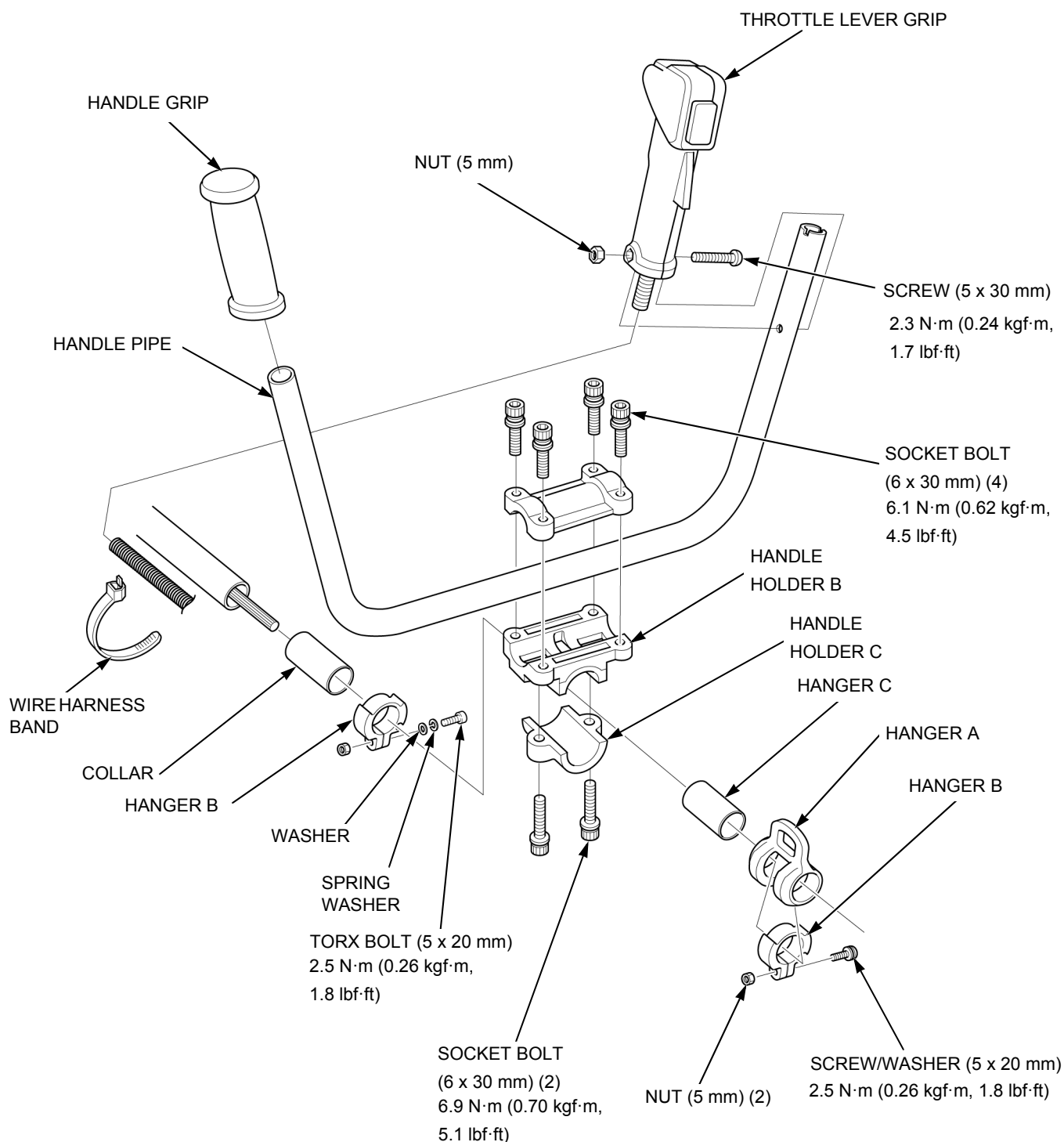



## HANGER HOLDER INSTALLATION

Install the hanger holder [1] at the position shown, and tighten the screw/washer [2] and torx bolt [3] to the specified torque.

**TORQUE: 2.5 N·m (0.26 kgf·m, 1.8 lbf·ft)**

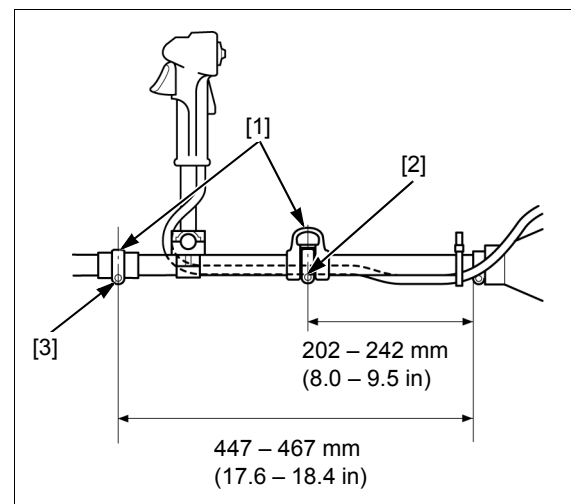

---

## MEMO

---

BLADE CUTTER/GEAR CASE/		NYLON CUTTER/GEAR CASE/	
DEFLECTOR REMOVAL/INSTALLATION .....	13-2	DEFLECTOR REMOVAL/INSTALLATION .....	13-3
DIMENSIONAL DRAWINGS .....	1-4	SERIAL NUMBER LOCATION .....	1-2
DIMENSIONS AND WEIGHTS SPECIFICATIONS .....	1-3	TORQUE VALUES .....	2-2
LOOP HANDLE/THROTTLE LEVER		TYPE CODE .....	1-2
REMOVAL/INSTALLATION .....	14-2		